

SPECIFICATIONS:

JB4W1&2 LOW VOLTAGE WATER LEVEL/LOW WATER CUTOFF SENSOR — is a dual purpose, in-pool electronic sensor with titanium probes. The sensors mount on brass rods that attach to a cast bronze junction box, which is mounted on a brass nipple that pours in the pool floor. The height of each sensor is individually adjustable for precise water level control.

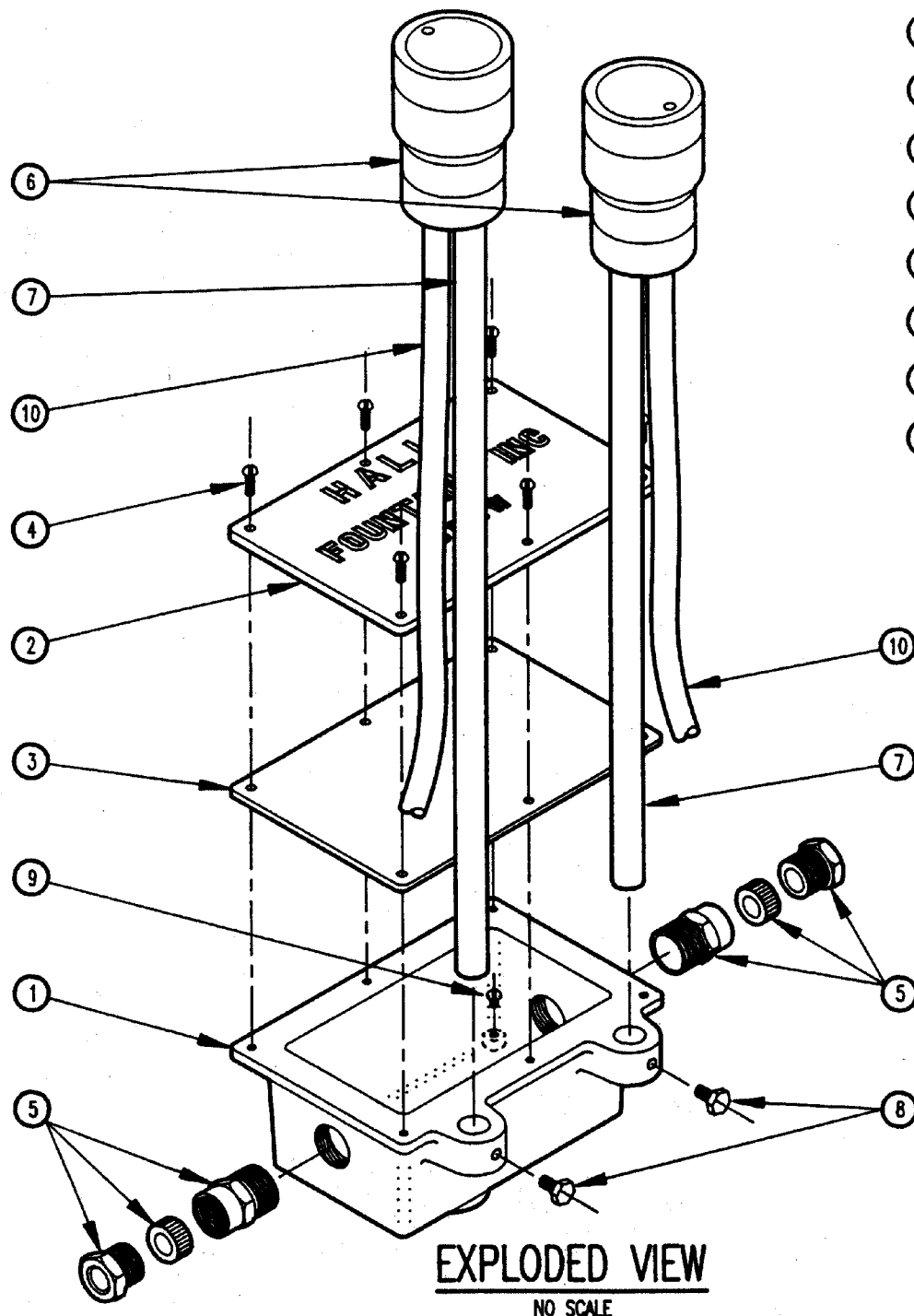

PARTS LIST:

ITEM	QTY.	DESCRIPTION
①	1	JUNCTION BOX BODY CAST BRONZE
②	1	JUNCTION BOX LID CAST BRONZE
③	1	JUNCTION BOX GASKET NEOPRENE
④	6	FLAT HEAD MACHINE SCREW STAINLESS STEEL
⑤	2	JUNCTION BOX CORD SEAL PHOSPHOR/BRONZE
⑥	2	SENSOR HEAD ASSEMBLY POLYPROPYLENE/TITANIUM
⑦	2	SENSOR HEAD ROD BRASS
⑧	2	HEX HEAD MACHINE SCREW STAINLESS STEEL
⑨	1	GROUNDING TERMINAL & SCREW COPPER/BRASS
⑩	2	SENSOR CABLE

JUNCTION BOX MUST BE POTTED WITH PARAFFIN (INCLUDED) AFTER COMPLETION OF WIRING TO PREVENT CONDENSATION. PACK BOTTOM WIRE ENTRANCE OF BOX TO CONTAIN PARAFFIN.

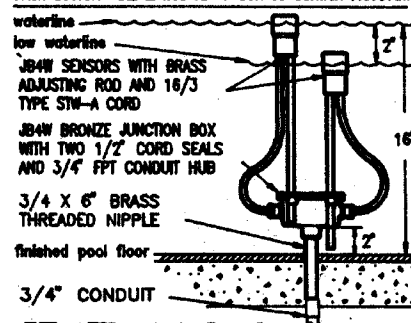

JB4W 1&2 Sensor

N.T.S. Typical Installation Detail

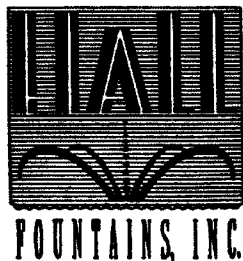

JB4W1&2

Low-Voltage Dual Function Water Level Sensor

5500 N.W.22 AVE. FT. LAUDERDALE, FL 33309

PHONE: 1-800-777-4255 * 1-954-484-8530